

SOYAL[®]

Nation Series

AR-727-E

Classic LCD Access & Attendance Controller

Classic LCD Access Controller, inherit V3 outlook design with upgraded Access Control function, supporting TCP/IP Networking to meet all Access Control applications.



LCD (128*64) menu setting

Intuitive menu operation, users can directly do function settings according to display message, no need to memorize the command set.

Classic LCD Access Controller

Inherit 727H-V3 controller's classic outlook, upgrading with much more multiple functions, over 20 years of perseverance have created durability and stability quality.

Four functional keys for Time Attendance

Duty on/off, Break out, Break return, Overtime on/off etc.

Features



Double Relay



Waterproof (IP54)



Complete Indicator



Dual-Band Frequency



Two Doors Control



Suitable for Extended Function



Web



Youtube

- RS-485 and TCP/IP communication interface
- Built-in Watch Dog to prevent the halting
- User capacity: 16,000; Event logs: 32,000
- Lift Contro: 64 floors/32 floors/16 floors
- Ingress Protection IP54
- Data redundancy while system disconnected, identify users and store event log up to 32000 records
- Access Mode: Card Only, Card or PWD, Card and PWD
- 63 auto-open zone settings and 16 sets of Auto-Open Zone editable
- WG port provides anti-pass-back function
- Built-in HTTP Browser for remote Access Control
- One more Exit Switch, Door Contact and Door Output to wiegand
- Built-in Multi-Output: Door Lock / Alarm / Arming / Duress / Security trigger signal
- 125kHz and 13.56MHz can be used simultaneously two channels
- TTL or RS-485 serial output for various application, lift control and Bluetooth Module
- Built-in 16 set of Alarm and 120 days of Holiday setting
- Including the input of door contact, offering the alarm system of both door opening too long and being forced to open
- Intelligent to shift for standalone or networking mode while system disconnected
- Support SCC encryption (SOYAL SECURITY COMMUNICATION) to enhance security of communication

SPECIFICATION

Communication interface	Host	RS485(9600 bps (N, 8, 1) / TCP/ POE
	Serial	UART PORT (Output only) / 9600 bps (N, 8, 1) X2
Frequency	125kHz / 13.56MHz / card simulation	
Supported Tags	125kHz	ISO18000-2: EM4001 and EM4095 compatible
	13.56MHz	ISO14443 Mifare Ultralight / Classic / Plus / DESFire / - EV1/ EV2 / NFC (card simulation)/ISO15693 / Felica
Crypto	13.56MHz: CC Certification: AES Crypto comply with EAL5+	
RFID Reading Range	125kHz: 5-15 cm / 13.56MHz: 2-5 cm	
UID Bits	64	
DI/DO	DI	Egress X2 / Door State X2
	DO	Security Output / Arming Output / Duress Output
	RO	Door Lock Relay / Alarm Relay
Doors/Floors Number	2 Doors / 64 Floors	
User Capacity	16,000	
Event Log	32,000	
Indicator	LED	6 Bi-Color LED Power / Alarm / Arming / OK / Error / In processing
	Buzzer	1
Extend Port	Tamper Switch / Tamper Output / WG In Port / WG Out Port	
Dimension (mm)	126(H)X91(W)X46(D)	
Housing Material	ABS	
Color	Gray	
Weight (g)	220±10	
Power Consumption	<5W	
Power Voltage	9-24VDC	
Ingress Protection	IP54	
Power Voltage	128*64 (4 line messages, 16 Characters each line)	
Environment	Operating Temperature	-20°C ~ +65°C
	Storage Temperature	-25°C to +70°C
	Operating Humidity	20%~90%
	Storage Humidity	5%~95%

WHAT WE OFFER

- ✔ **Reader Mode Supported**
 AR-727-E controller can also be set to Reader mode, with Wiegand output that can be integrated with various brands of controllers, with a dual-band format that turns into Wiegand dual-band Reader.
- ✔ **Real-time event log integration**
 After reading card, IP-based controller AR-727-E will actively send the event logs through port 8031 for the integration with the 3rd party program.
- ✔ **Auto-Schedule**
 AR-727-E special firmware connect with DO module AR-401RO16B, using Lift Control program enabling you to control each Digital Output and formulate a time schedule for each output, up to 64 . It's suitable for each various switching devices, such as lighting, sprinkler system, air conditioning, etc.
- ✔ **Auto-Open**
 The Wiegand reader Auto-Open time zone setting to control the infrared activation function / output the second set of door contact functions at a specific time.
- ✔ **Auto-Alarm**
 Built-in 16 sets of Alarm to output flash light, alarm clock, broadcast system, and each set of Alarm can set the output time.
- ✔ **With 2 sets of UART port**
 It can be applied to:
 - (1) 256-point Mailbox Management System
 - (2) Auto-scheduling control function-64-point DO control
 - (3) Printer integration
 - (4) Voice module (AR-721V-V2)
- ✔ **Double Door Control**
 Connected with Reader, it can manage 2 access control by a single unit AR-327-E. The second set of access control also has the exit switch, door contact status and door output control, can also set different access level (such as - can access Door A but can not access Door B).

INSTALLATION(mm)

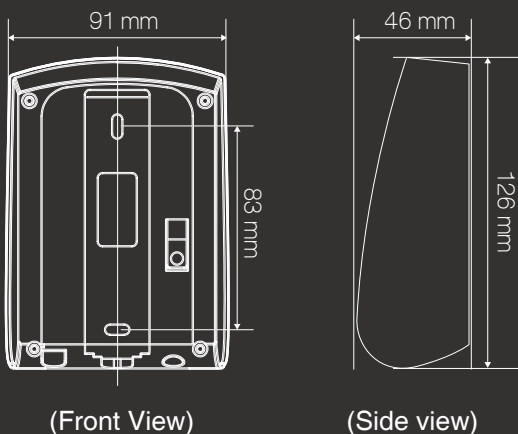

HOW TO ORDER

AR-727-EXR1121-X

Frequency
 B=125kHz
 D=13.56MHz
 S=125kHz+13.56MHz

RTC
 R=Built-in RTC

Communication
 1=RS485

Waterproof
 1=Weatherproof

Housing Material
 A=TCP/IP Module
 P=POE Features

Language(LCD)
 1=English/Chinese

Color
 2=Gray

APPLICATION & STRUCTURE DIAGRAM

● STANDALONE & NETWORKING ACCESS CONTROL

Anti Passback: restrict user to re-enter before exiting venue or increase security level by having access reader at the other side of the door. Both entering and exiting will required swipe card or keyfob for access.

AR-727-E can detect abnormal event with the door contact status in arming mode. When a forced entry or door opening too long, an alarm is generated and sent to the software, AR-727-E alarm output can be equipped with a flash buzzer as warning on site.

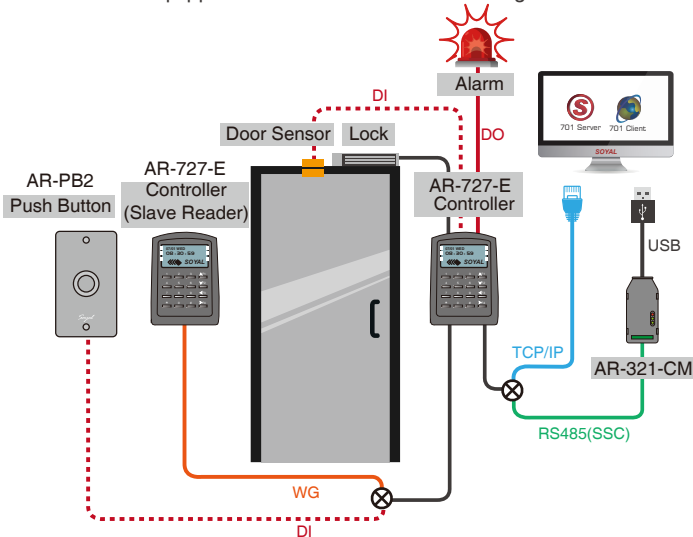

--16,000 User, 63 Timezone--

BUILT-IN HTTP WEB SERVER

IP-Based Controller has built-in HTTP WEB Server for Access Control, just input IP address, have it logged in to remotely control a single controller, enabling adding User card, time zone setting, review event logs, etc, even more can remotely open/close door regardless the brand of computer and smart phone. As long as there is a WEB browser, the remote management function can be achieved.



● ETC Long Range Access Control System

ETC Long Range Access Control is the tendency of Traffic Access Management, UHF Long Range Reader as WIEGAND input connected with Controllers AR-727-E Classic LCD Controller, when WIGAND reader detect viechel ETC label (FETC supported) the ETC number will be displayed on LCD for easy recording and tracking, bring the convenience and automation in management.

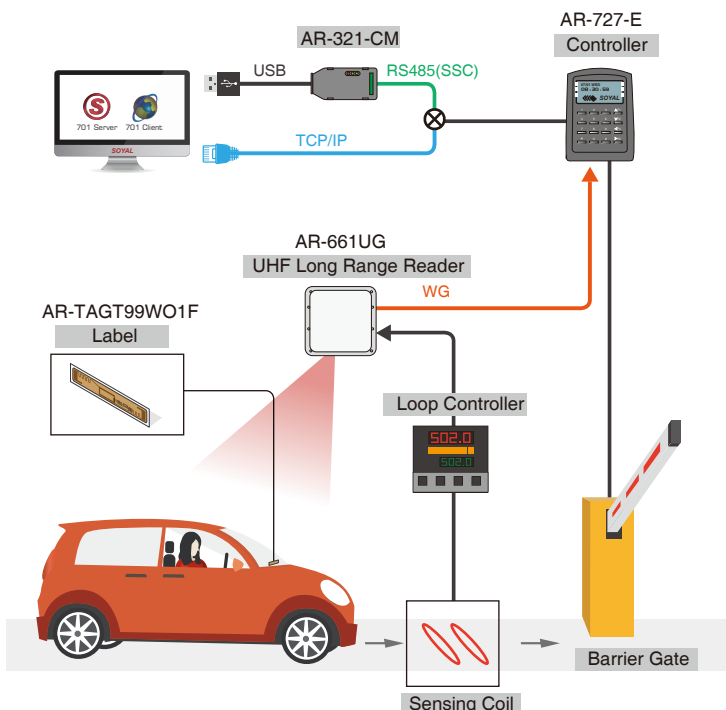

● Auto Alarm Function

16 sets of alarm setting, when the scheduled time is up (output time duration is adjustable), it outputs and can connect to external devices such as flash light, alarm-clock, broadcast system.

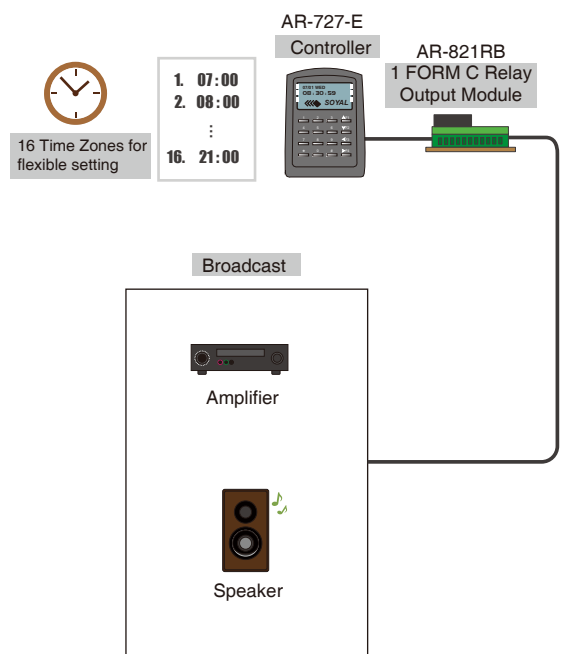

PERIPHERALS / ACCESSORIES

HIGH LEVEL SECURITY

• Anti-Cloning Kits



Mifare Key

Mifare Encryption

Encoder: AR-725-P
Authorization Tags
Software: Mifare Key



323D Master

Desfire Encryption

Encoder: AR-837-P
Authorization Tags
Software: 323D Master

• Expansion I/O Control

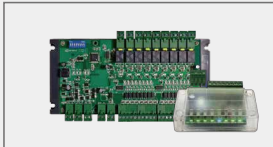

I/O Modules

AR-401 Series:
Multiple Channel I/O Module
AR-403 Series: Tiny Digital I/O Module

NETWORKING

• Software



701 Server 701 Client

File Based & Data Based Interchangeable Software for Access Control, Time Attendance, Status Monitoring and Configuration

701 Server & 701 Client



UdpUpdater

Firmware Upgrade
UdpUpdater



LiftControl

Remote Lift Control and Time Table Setting
LiftControl

• Signal/Interface Converter



POE Module

AR-MDL-RJ45-POE-12V12W



Isolated USB to RS-485 Ethernet to RS485

AR-321-CM

Isolated RS232 to RS-485 Converter
AR-321-CM-485232



Ethernet to RS485

AR-727-CM
AR-727-CM-IO-0804M (with I/O for Fire Alarm to open all doors)



AR-727-E

STANDALONE

• Input/Output



Locks

Magnetic Lock
AR-0600M-270
Electric Bolt Lock
AR-1207 Series
Cabinet Lock
AR-1211-P/AR-1213-P
Electric Strike
AR-YS-130NO/AR-YS-131NO



Door Sensor / Push Button / Alarm / Burglary Security System

• Multi-Door AntiPassback

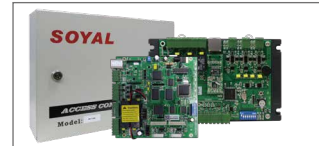

Multi-Door Control Series

AR-716-E16: 16 Doors IP Control Panel
AR-716-E18: 18 Doors IP Control Panel

• Extensive Applications (UDP/TCP)

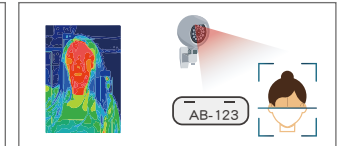

Infrared Thermo-Camera, LPR (License Plate Recognition)

• Nation Series



Keypad Access Controller

AR-721-H

Proximity Reader

AR-721-K

• External Relay Output

(Security / Arming / Duress / WIEGAND Unlock Door/Alarm)

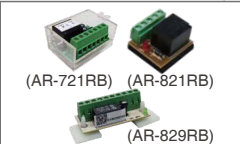

1 Form C relay with time delay

AR-721RB

1 Form C relay

AR-821RB

2 Form C relay

AR-829RB

• UART Port x 2

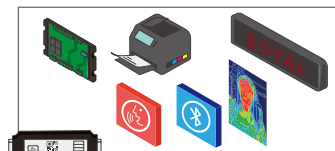

Lift Control / I/O Module / Printer / LED display / Voice Module / Bluetooth Module / Infrared Thermo-Camera

• Programming • Necessary

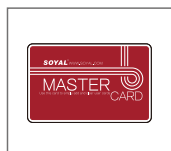

Keyless Editing

Self programmed master card



Power Supply

BP-W12-1500 (1.5A)
BP-W15-2400 (2.4A)



Proximity Tags

125kHz: EM
13.56MHz: Mifare Classic, Mifare Plus, Mifare Desfire, UltraLight
Tags Selection: Thin Card, Round Keyfob, Square Keyfob

FAQ

Q: What precautions to be aware of when upgrading AR-727H-V3 to AR-727-E?

A: Classic LCD Controller AR-727H has been launching over 20 years and applying widely in various installation sites, to meet the increased demand in more functionality, AR-727H has been upgraded from V3 to V5, this Q&A is major to remind distributors and installers there are some points to be aware of during the replacement in installation sites so that it can avoid unnecessary problems.



◀ Scan QR cod to view

Q: How to view event record in LCD controllers offline without computer ?

A: E-series LCD controller in standalone mode that can check and directly view event record from controller LCD display, through the menu setting help you quickly find the required function to check the event records one by one, such as entry and exit records and alarms. Events and other information.



◀ Scan QR cod to view



More FAQ