

•• Recessed Mounted



Specification: BR-1011

3/8" diameter Super Miniature Stubby switch

Press to fit

Standard 18" #22AWG Leads

Switch or magnet are available separately

Special leads available on request

Resistor, Diode and Supervisory Loop available on request

Colors: White, Brown, Grey

Dimension (mm):



Alternate Rare Earth Magnets:

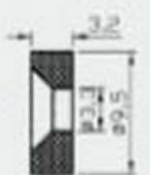

MN400
for BR-1011DM



MN600
for BR-1011DMWG