

# ANC2000B-W

Wireless Alarm Hub



### Features

- 32 Wireless Zones
- Bi-directional Communication, Transmission Range Up to 150m Open Space
- 16 Wireless Key Fobs (Remote Control)
- 4 Wireless Sirens
- Built-in Speaker
- Wi-Fi (IEEE 802.11)



Technical Specification	
Wireless Zones	32 Wireless Zones, Bi-Directional Communication, Transmission Range Up to 150m Open Space
Wireless Remote Control Number/Distance	16, Transmission Range Up to 80m Open Space
Video Out	Built-in Speaker
Wi-Fi	2.4GHz (IEEE802.11b/g/n)
Power	DC5V, Max 10W
Working Environment	-10°C~+55°C
Overall Dimensions\Weight	117.5mmL*115W*21.6H mm/<0.2kg
Installation	Desktop/Wall mounting

### Application

Scenario - Home



### Dimension (mm)

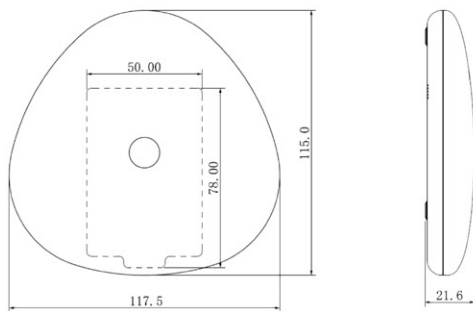

# AND1231-W

Wireless PIR



## Features

- 12m/90° Detecting Range/Angle
- Pet Immunity 18kg
- Bi-Directional Communication
- Transmission Range Up to 150m Open Space
- Built-in Tamper Switch
- Wall Mount, 2.2~2.5m Installation Height
- Two Level (Sensitivity)
- ABS Plastic
- CE, FCC, MABISZ

Technical Specification	
Name	Wireless Passive Infrared Sensor
Detection	Passive Infrared
Detection Range	12m×12m, 90°
Alarm Prompt	Red LED, Can be Set to Switch Off
Sensitivity	Two Level (Jumper)
Wireless Frequency	433MHz/868MHz/915MHz
Transmit Power	10dBm
Transmit Distance	150m Open Area/No Interference
Pet Immunity	≤18Kg
Resistance Light	6500LUX
Working Environment	-10°C~+50°C, humidity <95°
Overall dimensions/weight	105mm×62mm×41.3mm/0.1kg
Tamper	Unit protection and leaving-wall protection
Power	1×CR123A battery, 3V 50mA
Installation height	Wall mount, 2.2-2.5m
Certifications	CE, FCC, MABISZ

Product Appearance	
1	Case vandal-proof switch
2	Pyroelectric infrared detector
3	Sensitivity adjustment plunger pin
4	LED plunger pin
5	Motherboard PCB
6	Lithium battery
7	Antenna
8	Wireless module
9	Wall vandal-proof switch
10	LED

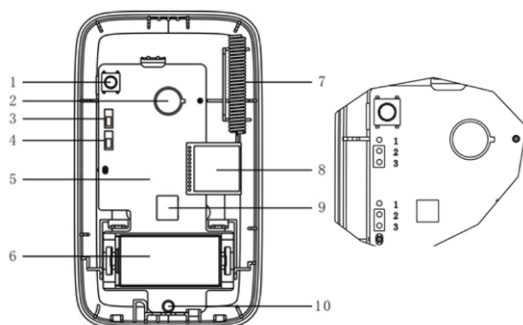

## Range of Detection

Detection range of the detector is shown in Figure 1-1. Horizontal angle of detection is 90°.

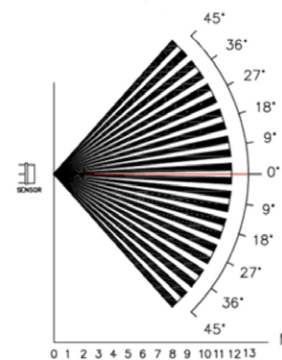

Figure 1-1

Range of detector is shown in Figure 1-2. Detection distance is 12m, and the closest distance is 1m.

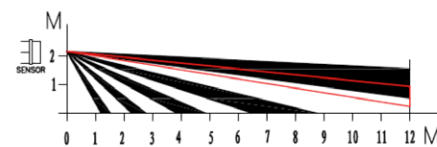

Figure 1-2

# AND311-W

Wireless Door/Window Contact



## Features

- Door/Window Sensor, 25-40mm Motion Distance
- Bi-Directional Communication
- Up to 150m Transmission Distance (Open Space/No Interference)
- Tamper Switch Equipped
- Screw or Glue to Mount
- ABS Plastic
- CE, FCC, MABISZ

Technical Specification	
Name	Wireless Door Sensor
Motion Distance	25-40mm
Alarm Prompt	Notification LED Light
Wireless Frequency	433MHz
Transmit Power	10dBm
Transmit Distance	150m(Open Area/No Interference)
Tamper	Front Cover and Rear Cover Protection
Power	1xCR123A Battery, 3V 50mA
Installation Way	Screw and Glue
Dimensions	84*39*22mm(L*W*H)
Weight	0.1kg
Temperature	-10°C~50°C
Humidity	< 95%
Installation	Screw or Glue to Mount
Certifications	CE, FCC, MABISZ

Dimension (mm)

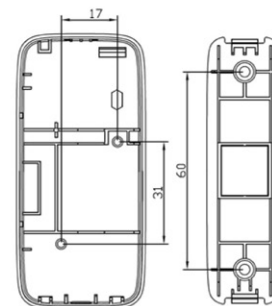

Product Appearance	
1	Wireless module
2	Vandal-proof switch I(case)
3	LED
4	Vandal-proof II(wall vandal-proof)
5	Reed switch
6	Battery
7	Magnetic

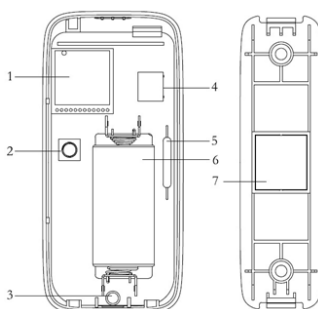

# ANA22-W

## Four-Key Remote Control



### Features

- Arm/Stay Arm/Disarm/SOS
- LED Indicator
- FSK, OOK Modulation Modes
- 433MHz
- Max Transmit Power +10 dBm
- Low Consumption, Current Under Sleep < 10nA
- Under +10dBm Output Power, TX Current is 19.8mA (FSK Transmit Mode)
- Super-LOW Current Power Down Mode (30nA OFF current, 50nA standby current)
- Data Transmission Rate: Max 100Kbps
- Battery Voltage Detection
- 128 bit AES Encryption Algorithm
- CE, FCC, MABISZ

Technical Specification					
Model	Description	Min	Regular	Max	Unit
Name	Wireless key fob				
Working voltage	1.8	3	3.6		V
Frequency		3.15	434	915	MHz
Max reflection power		9.2	9.6	10	dBm
Transmitting current	+10dBm 3.0V	18.9	19.8	21	mA
Data rate	FSK Modulation	0.1	4.8	100	Kbps
Key			4		
Temperature		-10°C		+50°C	
Ingress protection			IP20		
Dimension	L*W*H (mm)			62*30*14	

# ANA10-W

Wireless Siren



### Features

- Bi-Directional Communication
- Up to 700m Transmission Distance (Open Space/No Interference)
- Sound Intensity is 85dB (1m)
- Tamper Switch Equipped
- Wall Mount
- ABS Plastic

Technical Specification	
Name	Wireless Siren
Wireless Frequency	433MHz
Transmit Power	10dBm
Transmit Distance	700m (Open area/No interference)
Sound Intensity	85dB (1m)
Sound Set	On/Off
Tamper	Front Cover and Rear Cover Protection
Power	4 x CR123A Battery
Temperature & Humidity	-10°C~55°C < 95%
Installation Way	Wall Mount
Dimensions	98*55*26mm (L*W*H)
Weight	0.2kg

### Dimension (mm)

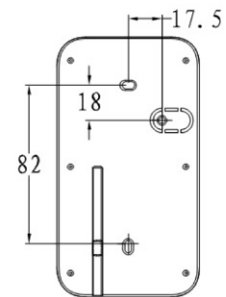

Product Appearance	
1	Wireless module
2	+12V power connector
3	Buzzer
4	Vandal-proof switch
5	Battery
6	LED

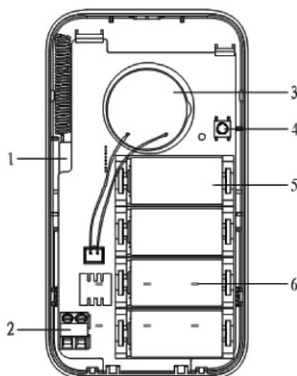

# FND122A-W

## Wireless Smoke Detector



### Features

- Infrared Photoelectric Sensor
- MCU Processing, Eliminate False Alarm
- Surface-Mount Device (SMD) Circuit Board Design
- High Detection Sensitivity
- Simple Ceiling Installation Using a Dedicated Bracket
- Low Battery Indication at Least 30 Days from Warning Signal
- Alarm Sound Level 80dB at 3m(10 Feet)
- Frequency: 433MHz



Technical Specification	
Name	Wireless Smoke Detector
Work Principle	Photoelectric Type
Alarm Sound Volume	80dB at 3m (10 feet)
Alarm Type	Audio and Optical Alarm
Normal Status	Red LED Flashes Once Every 90s
Alarm Status	Red LED Flashes and Buzzer Beeps Continuously
Low Voltage Status	Red LED Flashes Once Every 90s and Buzzer Beeps Every 90s
Low Battery Life	At Least 30 Days from Warning Signal
Work Voltage	Lithium Battery, DC3.6V
Standby Current	≤15uA
Alarm Current	≤50mA
Center Frequency	433MHz
Transmitting Power	10dBm
Transmission Distance	150 Meters(Open Area)
Work Temperature	-10°C~55°C
Work Humidity	≤ 95% (Non-Condensation or Icing)
Installation	Ceiling or Wall Mounting
Dimensions	103mm × 103mm × 41mm (L×W×T)
Weight	About 110g (Including Battery)

### Dimension (mm)

